



MANUFACTURERS OF THE WORLD'S FINEST FLOOR SANDERS

WWW.ESSEX-SILVER-LINE.COM

ESL17-SV Low Speed Rotary Polisher

2024 September Revised

Prices Subject to Change w/o notice



2/1/2024

Unpacking your new ESL17-SV:

When your package is delivered, check each of the 3 cartons carefully for signs of rough handling. If the ESL17-SV is damaged, notify the carrier immediately and request an inspection. Be sure to keep the cartons, packing inserts, packing lists and carrier's receipt until the inspector has verified your claim.

Essex Silver-Line's liability ceases when the carrier picks up the shipment. However, our customer service staff will be happy to furnish any information needed in connection with the claim and will attempt to expedite a resolution.

Please Read Before Operating Your New ESL17-SV:

Read the manual carefully and completely before attempting to operate the unit. This manual has important information for the use and safe operation of the machine. Always keep this manual handy.

This equipment has been engineered and manufactured to provide excellent performance and service. To ensure that your equipment will continue to perform as intended;

- Maintain and inspect equipment regularly
- Use only original Essex Silver-Line Supplied parts when servicing
- Operate equipment with care

If additional information is needed, please contact Essex Silver-Line at: 800 451-5560 or email info@essex-silver-line.com

All information and specifications printed in the manual are current at the time of printing; however, because of Essex Silver Line's policy of continual product improvement, we reserve the right to make changes at any time without notice.

Notes:

This image shows a blank sheet of white paper with horizontal ruling lines. The lines are evenly spaced and extend across the width of the page. There are no margins, text, or other markings on the paper.

FAILURE TO COMPLY WITH THE FOLLOWING WARNINGS AND INSTRUCTIONS WILL VOID THE WARRANTY.

WARNING!

- Do not operate the machine unless trained and authorized.
- Do not leave the machine unattended when plugged in. Unplug from outlet when not in use, before servicing, and when changing the brushes or pads.
- Use indoors only.
- Do not allow to be used as a toy. Close attention is necessary when used by or near children
- Do not bypass or defeat the safety “lock-out lever.”
- The machine was designed for use as per instructions and recommendations written in this manual. Any deviation from its proper use or purpose and the consequential damage that may occur is the sole responsibility of the end user.
- Do not use with damaged cord or plug. If the machine is not working as it should, or it has been dropped, damaged, left outdoors or dropped into water, take it to an authorized service center.
- Do not pull or carry by cord, use cord as handle, close a door on the cord or pull cord around sharp edges or corners. Do not run machine over cord. Keep cord away from heated surfaces.
- Do not unplug by pulling on cord. To unplug, grasp the plug, not the cord.
- Do not handle plug or appliance with wet hands.
- Make sure the machine is plugged into an electrical outlet with the same voltage and frequency rating as shown on the nameplate of the machine. Do not attempt to plug a 115-volt machine into a 230-volt outlet.
- Do not immerse or use this machine in standing water. Such use can cause electric shock.
- Keep the electrical supply cord from contacting the rotating brush or drive block.
- Do not expose machine to freezing temperatures.
- To avoid electric shock, do not expose the unit to rain. Store indoors only.
- Connect to a properly grounded outlet only. See “Grounding Instructions.”
- Turn off all controls before unplugging.
- When using an extension cord, use a 3 conductor-grounding cord, 12 gauge wire or heavier. Do not use more than 25’ of extension cord.
- Do not put any object into openings.
- Do not use with any opening blocked. Keep free of dust, lint, hair and anything that may reduce air flow.
- Do not operate machine in flammable or explosive areas.
- All servicing of Essex Silver Line equipment should be performed by Essex Silver Line.
- Keep hair, loose clothing, fingers and all parts of body away from openings and moving parts.
- Use extra care when cleaning near stairs.
- When servicing machine, use manufacturer’s supplied or approved replacement parts.
- Do not wrap cord too tightly when storing.
- Work only in well lit areas.
- This equipment is heavy. Use proper lifting techniques when lifting heavy equipment.

Proper Lifting Techniques:

1. Stand close to the load with your feet spread shoulder width apart. One foot should be slightly in front of the other for balance.
2. Squat down, bending at the knees (not your waist). Tuck your chin while keeping your back as vertical as possible.
3. Get a firm grasp of the object before beginning the lift.
4. Slowly begin straightening your legs, lifting slowly. Never twist your body during this step.
5. Once the lift is complete, keep the object as close to the body as possible. If the load's center of gravity moves away from your body, there is a dramatic increase in stress to the lumbar region of the back.

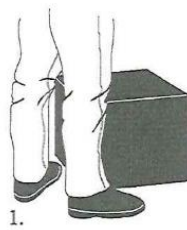

Notes:

[illegible]

Grounding Instructions:

This piece of equipment must be grounded. Should an electrical malfunction occur, grounding provides a path of least resistance for the electrical current- reducing the risk of electric shock. This piece of equipment is furnished with a cord that has a grounding conductor and grounding plug. The grounded plug must only be plugged into an appropriate outlet that is properly installed and grounded in accordance with all local codes and ordinances.

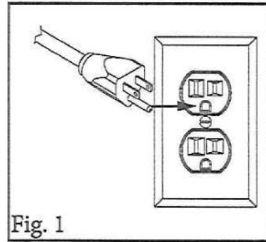

WARNING:

Connecting the equipment to an improperly grounded outlet can result in an increased risk of electric shock. A qualified electrician should be consulted if you are unsure that the outlet is properly grounded. Do not modify the plug provided with the equipment. If it will not fit the outlet, have a proper outlet installed by a qualified electrician.

This appliance is designed for use on a 120-volt circuit. The grounding plug provided looks like the plug illustrated in Figure 1. Replace the plug if the grounding pin is damaged or broken. The Green (or Green/Yellow) wire in the cord is the grounding wire. When replacing the plug, this wire must be attached to the grounding pin only.

DO NOT use extension cords.

Servicing:

In the event that your ESL17-SV requires service, please contact Essex Silver Line at: 800-451-5560 or email info@essex-silver-line.com.

Do not attempt repairs yourself.

Notes:

Final Assembly Instructions:

Please read the manual completely before proceeding to final assembly instructions.

Preparing The Machine For Operation

Your floor machine will operate in a wide variety of hard floors and carpet cleaning applications. Consult with Essex Silver Line to select the correct accessories for the job you are going to perform.

Brush, Pad Driver Installation

Lock the handle in the upright position and tip the machine back so it rests on the handle and wheels. Fit the three slots of the clutch plate in the back of the brush or pad driver over the three lugs of the drive plate (Fig. 1). Push it firmly into the position and turn it counterclockwise until it locks in place (Fig. 2).

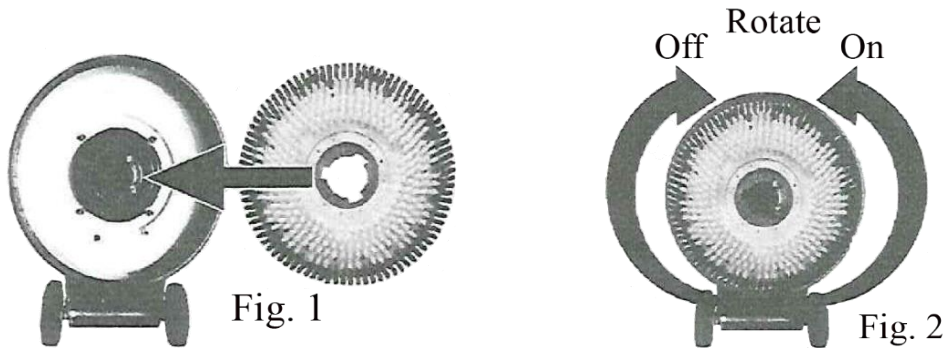

TO REMOVE PAD DRIVER: Tip the machine back so it rests on the handle and wheels. Turn the brush or pad driver clockwise until it disengages and lifts off. Do not store the machine with the brush or pad drivers installed.

Pad Installation

TO INSTALL PAD: Tilt the machine back on wheels until machine is resting on handle. Center the pad on the pad holder and place the pad onto the pad holder.

TO REMOVE PAD: Simply remove the pad from the pad holder by pulling it away from the pad holder with steady force.

1. The LOCK-OUT lever will automatically lock when you release the ON/OFF lever preventing the machine from being turned on until it is unlocked again.

Machine Operation:

1. Install the pad driver and pad, brush or attachment.
2. Plug in machine.
3. Lower the handle to the desired operating position.
4. Place both hands on the handle grips with your fingers around the ON/OFF lever which extends from one side to the other underneath the handle grips.
5. The safety LOCK-OUT lever is located underneath the right side handle grip and ON/OFF lever. To unlock the LOCK-OUT lever, use your right hand forefinger to press the lever down toward the back of the switch box.
6. While pressing the LOCK-OUT lever, pull the ON/OFF lever on either side of the handle to start the machine.
7. The LOCK-OUT lever will automatically lock when you release the ON/OFF lever preventing the machine from being turned on until it is unlocked again.

To Maneuver Your Floor Machine

1. Raise the handle and the machine will go to the right. The higher you raise it, the faster it will move.
2. Lower the handle and the machine will go left. The more you lower it, the faster it will move.
3. Practice on a smooth surface away from people and walls to gain experience in operating the unit before moving on to other surfaces.

Storage:

Wipe with a clean damp cloth after every use. Store in a clean dry place.

Cord Storage:

- Unplug the cord- Clean and inspect for damage.
- Wrap the cord around the left side handle grip.
- Do not wrap too tightly.

Feb. 1, 2024

Final Assembly Procedure for ESL17-SV

Low Speed Floor Machine

- 1) Before the final assembly, please check that you have received three cartons.
- 2) Carton one is labeled as Base Assembly, Carton two is labeled as Handle Assembly and Carton Three is labeled as Brush Cover Assembly
- 3) Open all cartons and pull out assemblies. The base assembly in Carton One is very heavy (75lbs), lift out properly after removing the top foam piece
- 4) Check for damage on the assemblies, start final assembly if no damage is found.

Tools Required for Assembly:

5/16" Allen Wrench (included)

A pair of adjustable wrenches (or three open end wrenches 9/16", 7/8" and 13/16")

Assembly of the Brush Cover to the Motor Base Assembly

- 1) Place motor base assembly upside down on the floor
- 2) Align the four holes on the Brush Cover to the four holes on the motor
- 3) Mount the Brush Cover using the four screws provided.
Finger tighten first, then use the a wrench to tighten firmly -
(star fashion tightening)



1



2



3

- 4) After making sure the Brush Cover is firmly attached, flip the Motor Base -
Right Side Up



4

- 5) Bring the handle to the upright Motor Base
- 6) Unscrew the nut (C13100) from the pivot axle screw (C22558)
Slide the screw from the handle bracket on the motor base frame
- 7) Insert the pivot tube on the handle between the handle bracket and align the holes
- 8) Insert the Pivot axle screw and nut, finger tighten first, then use a wrench



5

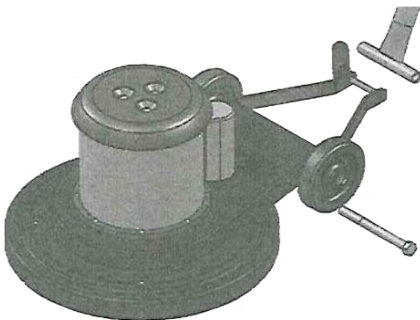

6

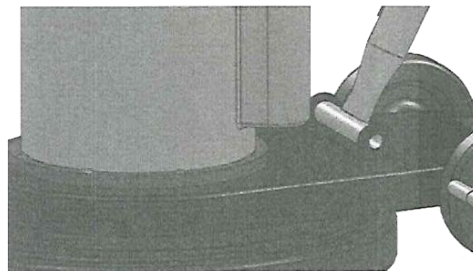

7

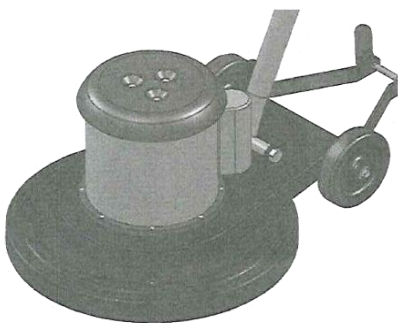

8

Assembly of the Locking Clamp to the Handle Assembly

- 1) Unfasten the nut (C11558) on the locking clamp handle assembly
- 2) Take the locking clamp assembly out of the braces
- 3) Insert the locking clamp assembly through the left and right braces and the Cord Hook Clamp Assembly.
- 4) Put the handle into the Up position (unlock) and start tightening the nut (CC11558) onto the spade bolt (C11536)

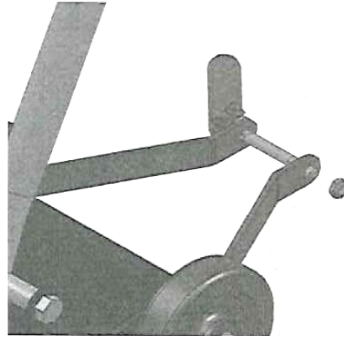

1

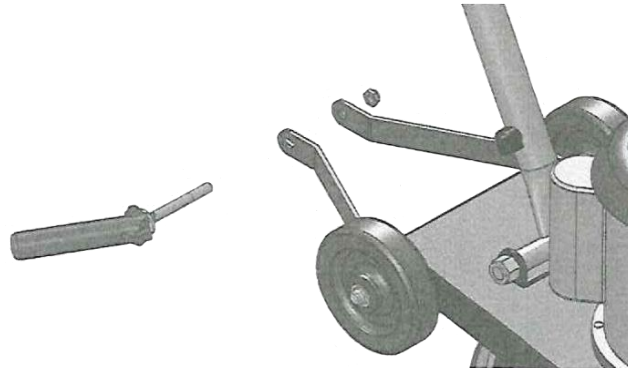

2

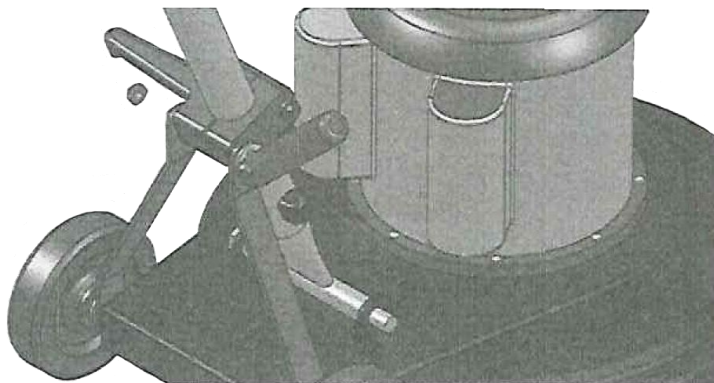

3 & 4

- 5) Cord hook clamp should move freely up and down on the handle when the locking handle is in the unlock position (UP)
- 6) Stop and lock the handle (down position) in several locations on the handle
- 7) Tighten the nut by hand until you feel the handle locks and unlocks firmly.
Test in several locations, the clamp should move freely when unlocked
- 8) Assembly is done, review pad driver installation before installing your pad driver.

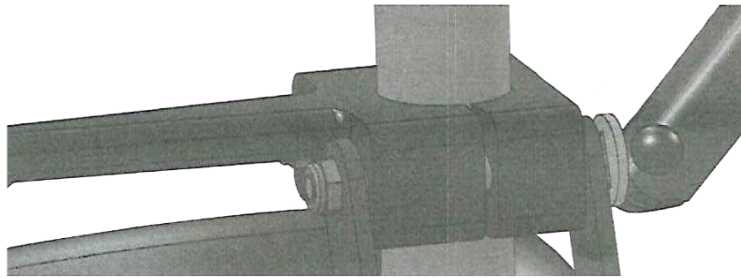

5

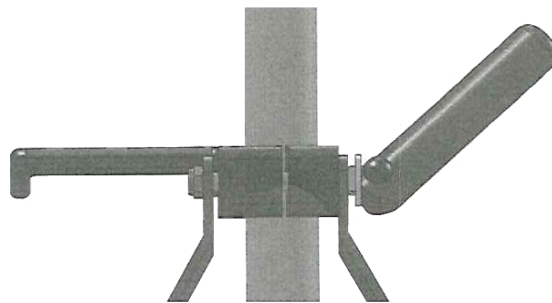

6 & 7



8

ESL17-SV

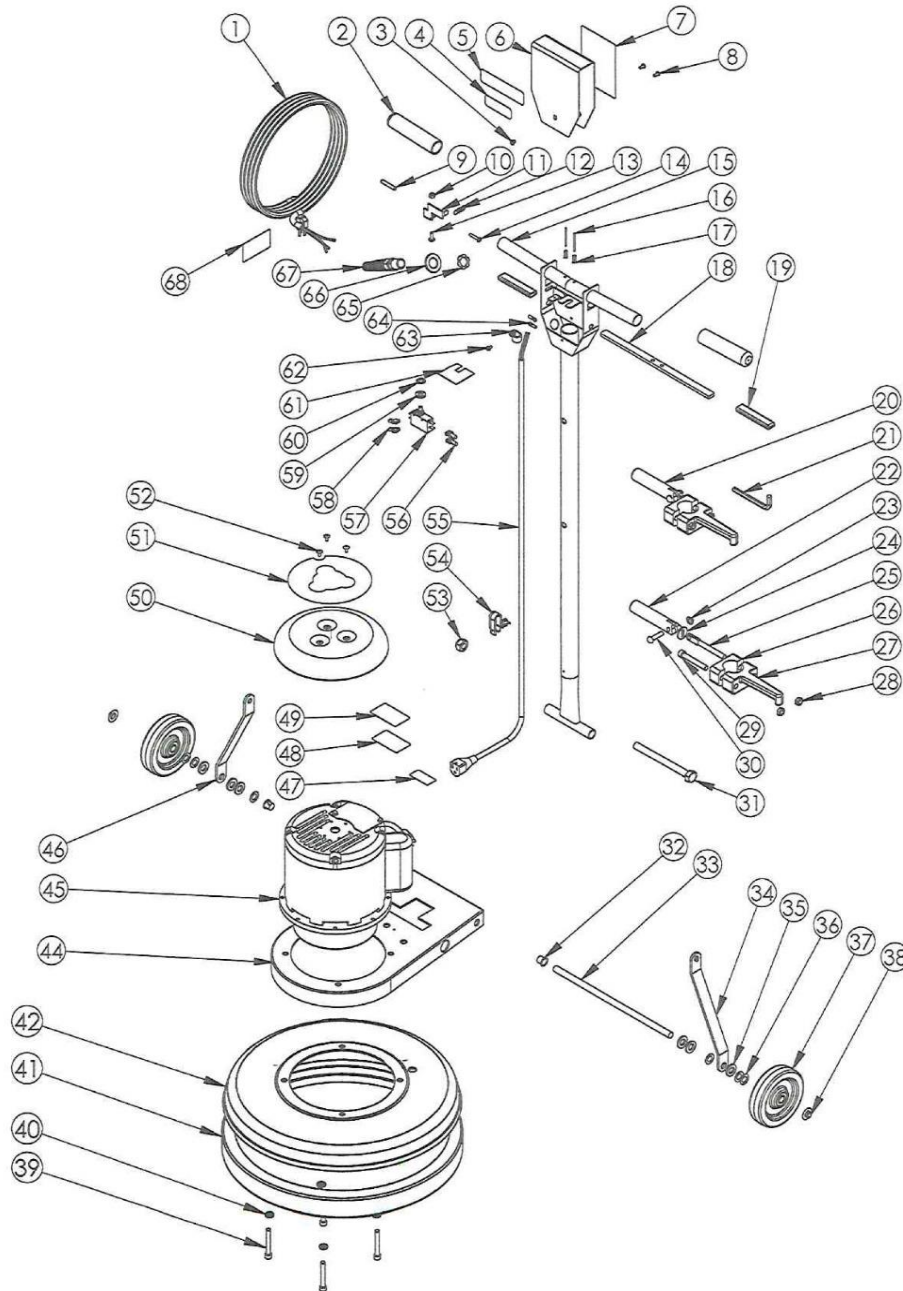

Item #	Part Number & Description	Qty
1	EDI-B11487 Power Cord, 14-3, 50 ft, SJTW	1
2	EDI-K11498 Grip	2
3	EDI-C11528 Screw, 10-32 X .25 in	1
4	EDI-H12066 Label, 0.5 HP, Saturn	1
5	EDI-H11831 Label, EDIC, Black-Silver	1
6	EDI-D11496B Switch Box Cover, Black	1
7	EDI-H11493 Label, Safety, Floor Machine	1
8	EDI-C11529 Screw, 10-32 X .375 in	2
9	EDI-K11519 Lever Grip, Lockout, Black	1
10	EDI-C00278 Locknut, 10-32, Nylon, SS	1
11	EDI-D11494 Lockout Bracket	1
12	EDI-D11524 Spring, Lockout	1
13	EDI-C90007 Screw, 10-32 X .625 Phillips, Truss Head, SS	4
14	EDI-C11491 Screw, 10-32 X 1 in, SS	1
15	EDI-D11479 Handle, Chrome, Floor Machine	
16	EDI-C00306 Roll Pin, .125 X 1.75	2
17	EDI-D11523 Spring, Trigger	2
18	EDI-D11495 Trigger, Zinc Plated	1
19	EDI-K11520 Lever Grip, Trigger, Black	2
20	EDI-11507A Assembled Locking Handle, Cord Hook	1
21	EDI-C11619 Allen Wrench, .31 in	1
22	EDI-D11497 Handle, Locking Clamp	1
23	EDI-C11538 Cap Nut, .31 in, Push-On	1
24	EDI-C00259 Washer, Slotted, Zinc	1
25	EDI-C11536 Spade Bolt, .375-16 X 4 in	1
26	EDI-D11507 Cord Hook Clamp	1
27	EDI-D11507-2 Cord Hook Body	1
28	EDI-C11558 Locknut, .375-16, Nylon	2
29	EDI-C11502 Socket Cap Screw, .375-16 X 2.5 in	1
30	EDI-C11537 Dowell Pin, .31 X 1.5 in	1
31	EDI-C13101 Screw, Hex Cap, M-14-2.0	1
32	EDI-K00674 Bushing, .50 in, Nylon	2
33	EDI-D11510 Axle, Floor Machine	1
34	EDI-D11482 Handle Brace, Right, Black	1
35	EDI-C00240 Washer, Shoulder, Nylon	6
36	EDI-C11559 Washer, .515 X .875 X .032	6
37	EDI-G11943 Wheel, 5 in Saturn	2
38	EDI-C02305 Cap Nut, .5in Push-on	2
39	EDI-C11501 Socket Cap Screw, .31 - 18	4
40	EDI-C00251 Lockwasher, .31, Split	4
41	EDI-E11477 Bumper, 17 in Floor Machine	1
42	EDI-D11485B 17 Inch Brush Cover	1

Item #	Part Number & Description	Qty
44	EDI-D11483 Frame, Motor, Black	1
45	EDI-G11468 Motor w/Gearbox, 1.5HP	1
46	EDI-D11481 Handle Brace, Left, Black	1
47	EDI-H10976-1 Label, UL STD 561-507	1
48	EDI-H00565-5 Label, Serial #, Standard	1
49	EDI-H03545 Cover, Serial #, Label	1
50	EDI-D11490B Drip Cover, Black	1
51	EDI-H12913 Label, Drip Cover White	1
52	EDI-C11916 Screw 10/32 x .375 Phillips	3
53	EDI-C13100 Nut, 9/16-12 Nylon	1
54	EDI-B10734 Strain Relief, Handle	1
55	EDI-B11513 Cord, Handle, 14-3 SJTW	1
56	EDI-B11762 Terminal Lug, Nylon, Female	2
57	EDI-B11465 Switch, DPST, Pushbutton	1
58	EDI-B00177 Terminal Lug, Female, OD .25 x .032	2
59	EDI-C00252 Washer, .375 in, Flat	1
60	EDI-C11541 Washer, .75 in, Star	1
61	EDI-B11518 Switch Insulation	1
62	EDI-C00284 Screw, 10-32 X .375 Ground	1
63	EDI-B00187 Cable Clamp, Nylon, .43 in.	1
64	EDI-B00180-10-3 Ring Terminal, #10 Center	2
65	EDI-B11505 Strain Relief Nut, Metal	1
66	EDI-C11560 Washer, .93 ID X 1.5 OD	1
67	EDI-B11504 Strain Relief, Metal	1
68	EDI-H02548-2 Label, Important, Cord	1

